

PC Mount Speakers*

Round Plastic Frame Types

Part Number	Frame Diameter (mm)	Frame Depth (mm)	Rated Power (Watts)		Cone Material	Resonant Frequency (Hz)	Frequency Response (Hz)	SPL (dB)	Magnet Type	Net Weight (Grams)	Termination & Spacing
			Nom.	Max.							
SR900R-PC	23	8.7	0.1	0.2	Mylar	850 ± 20%	Fo ~ 3500	89	Rare Earth	3.6	2 Pins - 10mm
S100RMF-PCR	27	8.8	0.1	0.2	Mylar	670 ± 20%	Fo ~ 7000	78	Rare Earth	7.8	2 Pins - 5mm
S110R-PC	30	12.0	0.15	0.2	Mylar	1000 ± 20%	Fo ~ 5500	82	Rare Earth	10.0	2 Pins - 15mm
S125R-PC	32	15.0	0.15	0.2	Mylar	1100 ± 20%	Fo ~ 4000	83	Rare Earth	12.9	2 Pins - 17.5mm

Square Plastic Frame Types

Part Number	Frame Diameter (mm)	Frame Depth (mm)	Rated Power (Watts)		Cone Material	Resonant Frequency (Hz)	Frequency Response (Hz)	SPL (dB)	Magnet Type	Net Weight (Grams)	Termination & Spacing
			Nom.	Max.							
S150SL-PC	39.6 x 42.5	4.8	0.25	0.5	Mylar	450 ± 20%	Fo ~ 5000	83	Rare Earth	7.8	2 Pins - 4.5mm

SR900R-PC

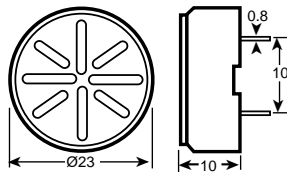

S100RMF-PCR

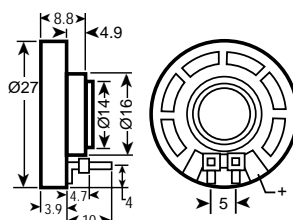

S110R-PC

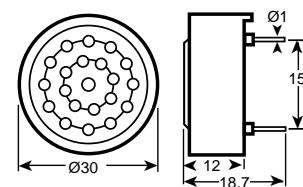

S125R-PC

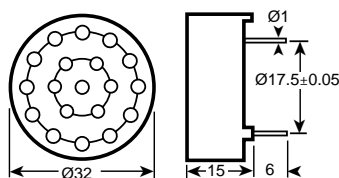

S150SL-PC

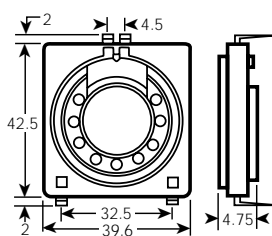

Surface Mount Speakers*

Surface Mount Speakers

Part Number	Frame Diameter (mm)	Frame Depth (mm)	Rated Power (Watts)		Cone Material	Resonant Frequency (Hz)	Frequency Response (Hz)	SPL (dB)	Magnet Type	Net Weight (Grams)
			Nom.	Max.						
SR800SMT	20	5.0	0.1	0.2	Mylar	1000 ± 20%	Fo ~ 11000	74	Rare Earth	2.6

SR800SMT

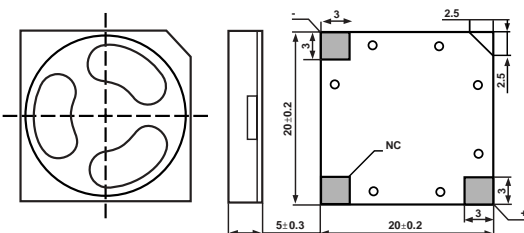

*Standard voice coil impedance 8 ohms ± 15%. These speakers can be supplied with a variety of voice coil impedances. The most common impedances are 4, 16, 32, 45 and 100 ohms.