

General Purpose Speakers*

Round Metal Frame Types

Part Number	Frame Diameter (mm)	Frame Depth (mm)	Rated Power (watts)		Resonant Frequency (Hz)	Frequency Response (Hz)	SPL (dB)	Net Weight (Ounces)
			Nom.	Max.				
S150RN	40.0	15.8	0.25	0.5	600 ± 20%	Fo ~ 5000	83	0.79
S175RN	45.0	16.6	0.25	0.5	600 ± 20%	Fo ~ 5000	83	0.87
S200RN	50.0	18.0	0.25	0.5	550 ± 20%	Fo ~ 5000	83	1.36
S225RN	57.0	19.0	0.25	0.5	400 ± 20%	Fo ~ 5000	84	1.41
S250RN	65.0	21.4	0.5	1.0	380 ± 20%	Fo ~ 5000	84	1.51
S275RN	70.0	21.8	0.5	1.0	330 ± 20%	Fo ~ 6000	84	1.61
S300RN	77.0	23.2	0.5	1.0	250 ± 20%	Fo ~ 6000	84	1.98
S350RN	90.0	27.3	1.0	3.0	200 ± 20%	Fo ~ 8000	86	2.04
S400RN	100.0	33.8	1.0	3.0	150 ± 20%	Fo ~ 10000	86	2.40

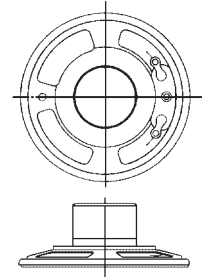

Square Metal Frame Types

Part Number	Frame Diameter (mm)	Frame Depth (mm)	Rated Power (watts)		Resonant Frequency (Hz)	Frequency Response (Hz)	SPL (dB)	Net Weight (Oz)	Mounting Dimensions Dia. (mm)
			Nom.	Max.					
S200SN	50.0	18.0	0.2	0.4	450 ± 20%	Fo ~ 5000	84	1.46	56.5
S250SN	65.0	21.4	1.0	2.0	350 ± 20%	Fo ~ 5000	84	1.65	75.0
S300SN	77.0	25.0	1.0	2.0	250 ± 20%	Fo ~ 6000	84	1.98	84.5
S350SN	90.0	27.0	2.0	3.0	200 ± 20%	Fo ~ 8000	86	2.04	105.0
S400SN	100.0	33.6	3.0	5.0	160 ± 20%	Fo ~ 10000	86	2.59	114.0

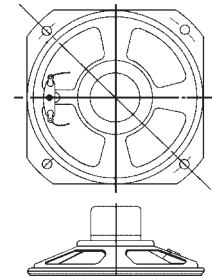

Telecommunications Speakers

Receivers

Part Number	Frame Diameter (mm)	Frame Depth (mm)	Rated Power (mW)		Voice Coil Impedance (Ohms)	Frequency Response (Hz)	SPL (dB)	Magnet Type	Net Weight (Ounces)
			Nom.	Max.					
DR1002RF-32	10.0	2.4	5	10	32 ± 15%	300 ~ 3500	113	Ferrite	0.6
DR1303RF-32	12.9	2.5	20	40	32 ± 15%	300 ~ 3500	116	Ferrite	1.0
DR1305RF-32-SPG	13.0	5.2	10	20	32 ± 15%	200 ~ 3500	101	Ferrite	1.3
DR1407RF-100	13.6	6.6	20	40	100 ± 15%	200 ~ 3800	104	Ferrite	2.0
DR1506RF-32-SPG	15.0	5.7	1	2	32 ± 15%	300 ~ 3400	106	Ferrite	1.1
DR2114RF-150	21.0	14.2	20	40	150 ± 15%	300 ~ 5000	105	Ferrite	6.0

DR1002RF-32

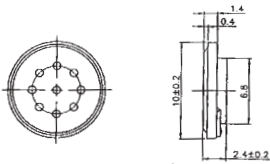

DR1303RF-32

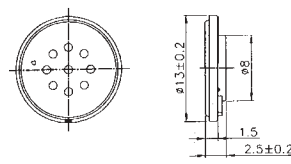

DR1305RF-32-SPG

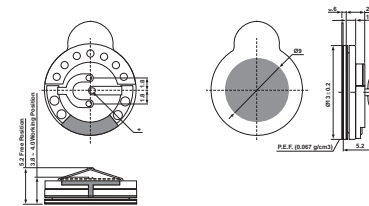

DR1407RF-100

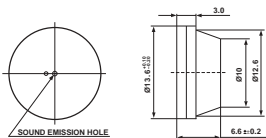

DR1506RF-32-SPG

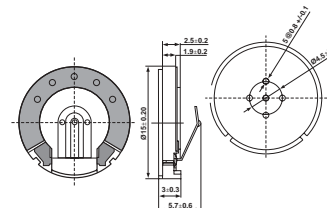

DR2114RF-150

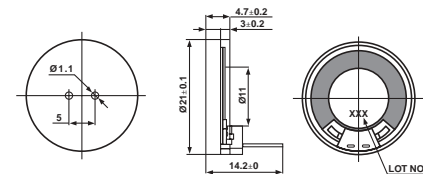

*Standard voice coil impedance 8 ohms ± 15%. These speakers can be supplied with a variety of voice coil impedances. The most common impedances are 4, 16, 32, 45 and 100 ohms.